



# EV6-225S(6V225Ah)



## Specification

Cells Per Unit	3
Voltage Per Unit	6V
Capacity	225Ah@20hour-rate to 1.75V per cell @25°C
Weight	Approx. 32.0 Kg (Tolerance ±5%)
Internal Resistance	≤1.9 mΩ (Full Charge Condition @25°C)
Terminal	Default F14(M8)
Max. Discharge Current	2250A (5 sec)
Cold Cranking Ampere(CCA)	760A
Maxi. Charging Current	67.5A
Reference Capacity	C <sub>3</sub> 162.0Ah
	C <sub>5</sub> 183.5Ah
	C <sub>10</sub> 205.0Ah
	C <sub>20</sub> 225.0Ah
Float Charging Voltage	6.80 V~6.90 V @ 25°C Temperature Compensation: -3mV/°C/Cell
Cycle Use Voltage	7.30 V~7.40 V @ 25°C Temperature Compensation: -4mV/°C/Cell
Operating Temperature Range	Discharge: -20°C~60°C Charge: 0°C~50°C Storage: -20°C~60°C
Normal Operating Temperature Range	25°C ±5°C
Self Discharge	RITAR Valve Regulated Lead Acid (VRLA) batteries can be stored for up to 6 months at 25°C and then recharging is recommended. Monthly Self-discharge ratio is less than 3% at 25°C. Please charged batteries before using.
Container Material	A.B.S. UL94-HB, UL94-V0 Optional.



EV ( Electric Vehicle ) series is specially designed for frequent discharge deep cycle application. By using the specially designed active material, strong grids and thick plate construction, the EV series battery offers reliable performance in high load situations and could provide competitive cycle performance. It is suitable for Electric Vehicle and Golf cart, Floor Machines, Forklifts, Aerial lifts, Robotics, Marine, RV, Mobility and Medical Equipment, and most outdoor application.



## Dimensions

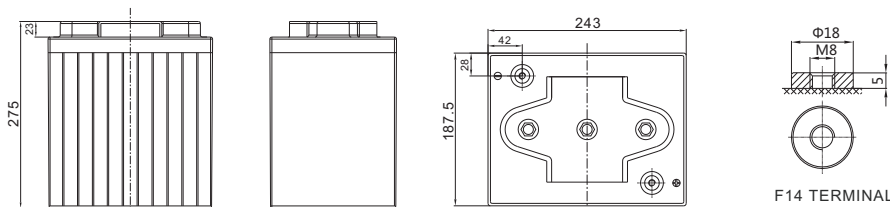

Length	243±2mm (9.57 inches)
Width	187.5±2mm (7.38 inches)
Height	275±2mm (10.8 inches)
Total Height	275±2mm (10.8 inches)
Terminal	Value
M5	6-7 N·m
M6	8-10 N·m
M8	10-12 N·m

Unit: mm

### Constant Current Discharge Characteristics : A(25°C)

F.V/Time	15MIN	30MIN	1HR	2HR	3HR	4HR	5HR	8HR	10HR	20HR
1.60V	381.6	238.9	132.0	78.3	60.9	47.9	40.7	26.8	21.6	11.71
1.65V	364.8	229.3	127.4	75.8	59.0	46.6	39.7	26.5	21.4	11.53
1.70V	341.7	219.2	123.3	73.3	57.4	45.3	38.7	26.1	21.1	11.39
1.75V	317.9	209.5	118.8	70.7	55.7	44.2	37.7	25.7	20.8	11.25
1.80V	293.6	200.2	114.3	68.2	54.0	42.9	36.7	25.3	20.5	11.14
1.85V	243.6	172.5	102.5	62.5	49.9	39.9	34.2	23.7	19.3	10.57

### Constant Power Discharge Characteristics : W/Cell(25°C)

F.V/Time	15MIN	30MIN	1HR	2HR	3HR	4HR	5HR	8HR	10HR	20HR
1.60V	667.0	433.8	248.0	148.3	116.3	91.9	78.5	52.3	42.6	23.1
1.65V	647.2	420.9	240.9	144.3	113.2	89.8	76.8	51.8	42.1	22.7
1.70V	615.2	406.3	234.5	140.3	110.6	87.6	75.0	51.1	41.5	22.5
1.75V	580.8	392.4	227.3	136.1	107.8	85.7	73.4	50.5	41.0	22.2
1.80V	543.9	378.8	219.9	131.8	104.9	83.6	71.8	49.8	40.5	22.0
1.85V	457.7	329.5	198.4	121.5	97.4	78.0	67.2	46.8	38.2	21.0

(Note) The above characteristics data are average values obtained within three charge/discharge cycle not the minimum values. The battery must be fully charged before the capacity test. The C<sub>20</sub> should reach 95% after the first cycle and 100% after the third cycle.



**EV6-225S (6V225Ah)**



**Charge Characteristic Curve for Cycle Use(IUUU)**

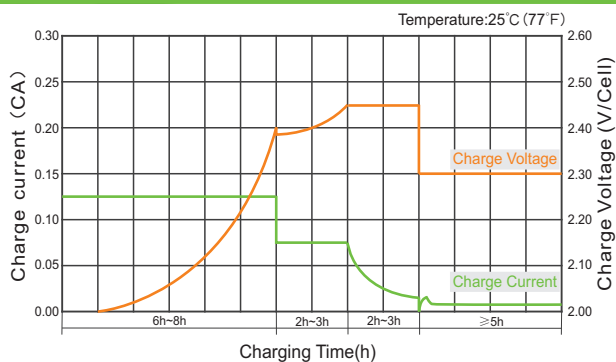

**Charge Characteristic Curve For Cycle Use(III)**

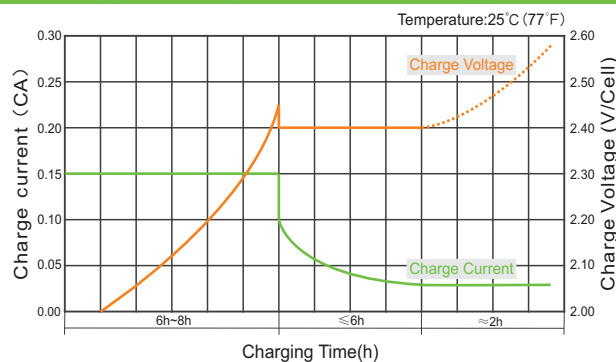

**Discharge Characteristics Curve**

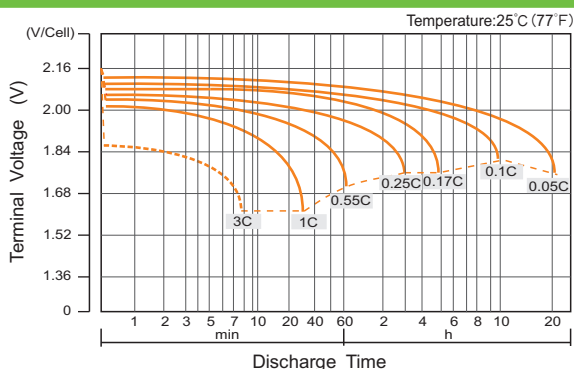

**Relationship Between Charging Voltage and Temperature**

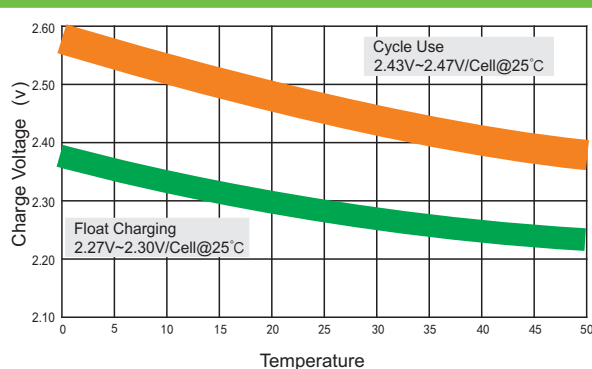

**Cycle Life in Relation to Depth of Discharge**

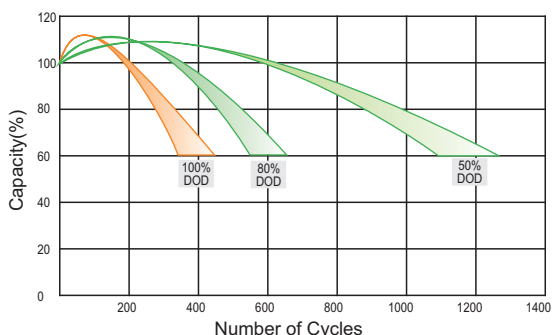

**Storage Characteristics**

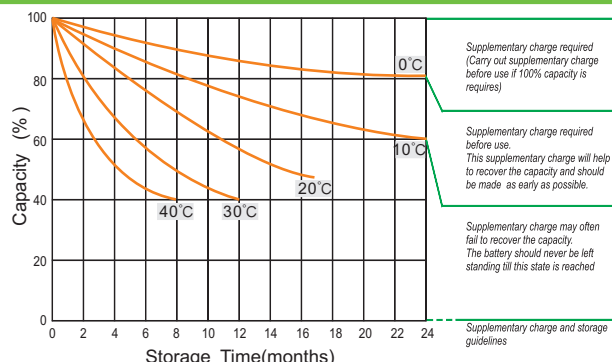

**Relationship of OCV And State of Charge(20°C)**

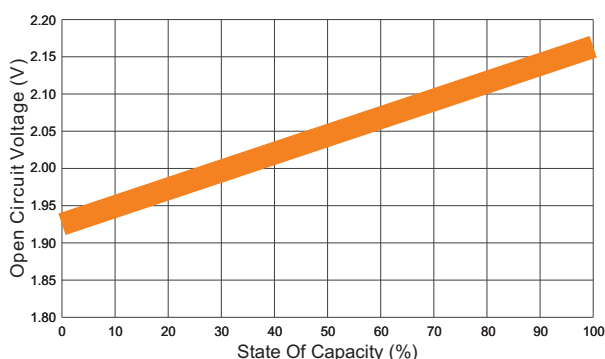

**Temperature Effects on Capacity**

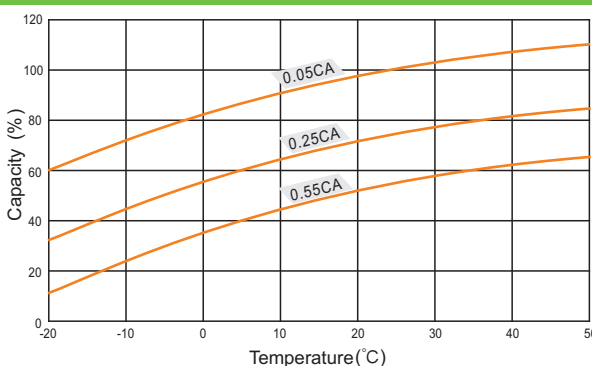

(Note) All above information shall be changed without prior notice, RITAR reserves the right to explain and update the latest information.

**HENGYANG RITAR POWER CO.,LTD.**  
**RITAR POWER (VIETNAM) CO.,LTD.**  
 URL: [www.ritarpower.com](http://www.ritarpower.com)

Add: 10th Floor, Tower C, 1st Building, Software Industry Base, No.81, Xuefu Road, Nanshan District, Shenzhen, Guangdong, China 518057  
 Tel: +86-755-33981668/83475380 Fax: +86-755-83475180 E-mail: [sales@ritarpower.com](mailto:sales@ritarpower.com) Version 23A-1-C